

## 50kHz-22GHz Low Noise Amplifier



### Product Overview

AT-LNA-0022-3503H is high gain low noise amplifier with 35dB gain in the frequency of 50kHz-22GHz. The DC power requirement is +12V/120mA. The module is with SMA connector, which is compatible with 2.92mm.

The amplifier can also be used as for optical modulator driver due the to excellent low frequency performance down to 50kHz.

More information, please visit [www.atmicrowave.com](http://www.atmicrowave.com)

### Advantages

- ✓ Frequency: 50kHz-22GHz
- ✓ Small signal gain: 35dB
- ✓ NF=3dB
- ✓ Vout=4Vpp

### Application

- ✓ 5G Communication
- ✓ Test Equipment
- ✓ Optical Modulator Driver
- ✓ Radar System

### Key Features

Parameter	Min	Typical	Max
Frequency		50kHz-22GHz	
Gain	33dB	35 dB	
NF (0.1-20GHz)		3dB	4.5dB
P1dB		+15dBm	
Psat		+16dBm	
Output Vpp		4Vpp	
Drain Supply	+8V	+12V	+15V
Current		120 mA	
Input Return Loss		-10dB	
Output Return Loss		-10dB	
Spec Temp		25C	





# AT-LNA-0022-3503H

50kHz-22GHz Low Noise Amplifier

## Mechanical Information

Item	Description
Input Port	SMA Female
Output Port	SMA Female
Case Material	Copper
Finish	Gold Plated
Weight (Without Heatsink)	50g
Size:	45X34X9.5 mm

## Absolute Maximum Ratings Table

Parameter	Value
Drain Supply	+16V
RF Input Power	+15 dBm
Input Vpp	3.56Vpp
Operating Temperature(note)	-20 to + 70C
Storage Temperature	-65 to +150C

Note: -40 to +85C is available according to request.

## Notes:

1. Datasheet may be changed according to update of MMIC, Raw materials , process, and so on.
2. This data is only for reference, not for guaranteed specifications.
3. Please contact AT Microwave team to make sure you have the most current data

## Part Number Selection Guide

Item	Description
PN	Stand Module with DC Power Supply
<b>PN-LCBT</b>	<b>L</b> ow Cost, <b>C</b> ompact <b>B</b> ench- <b>T</b> op, +220V Supply with AC/DC Adapter





# AT-LNA-0022-3503H

50kHz-22GHz Low Noise Amplifier

## Test Data (25C)

Please note that test curves will vary slightly from unit to unit.

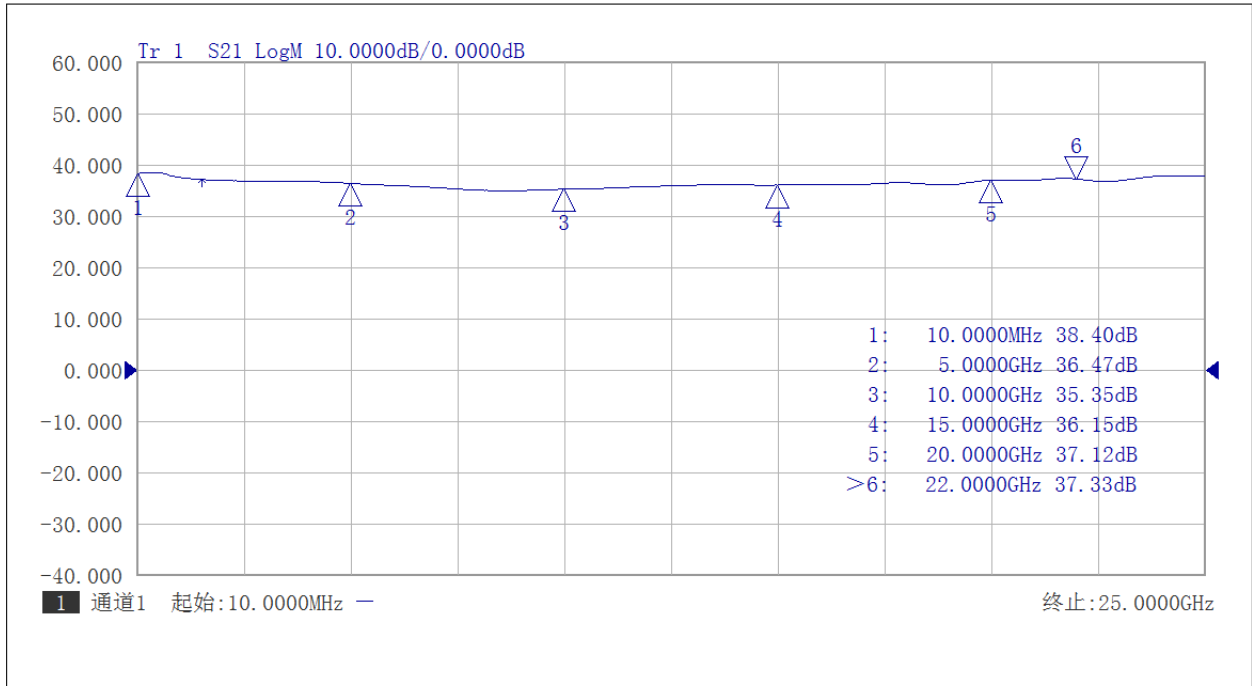

Gain vs Frequency 10MHz-22GHz

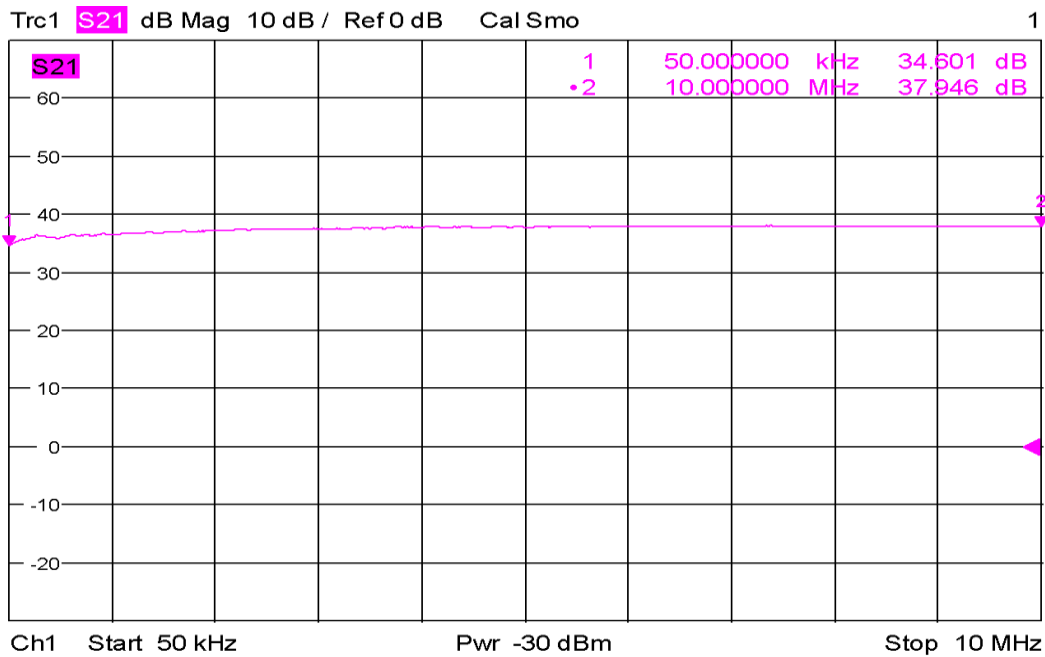

Date: 15.SEP.2021 12:35:06

Low Frequency Gain 50kHz to 10MHz



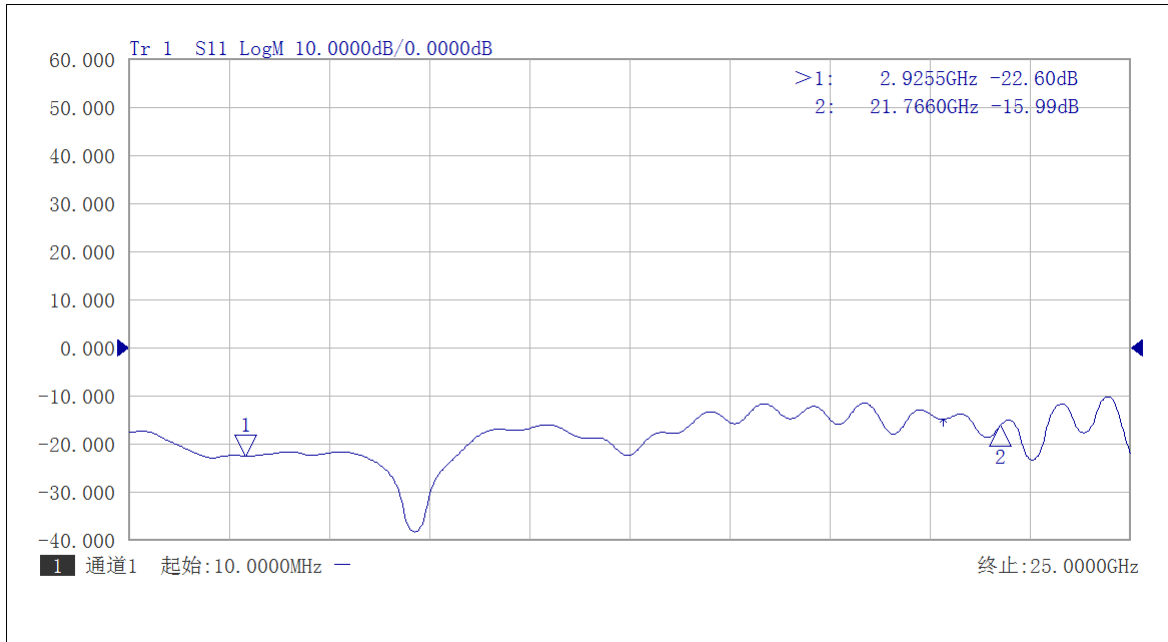

Input Return Loss vs Frequency 10MHz-22GHz

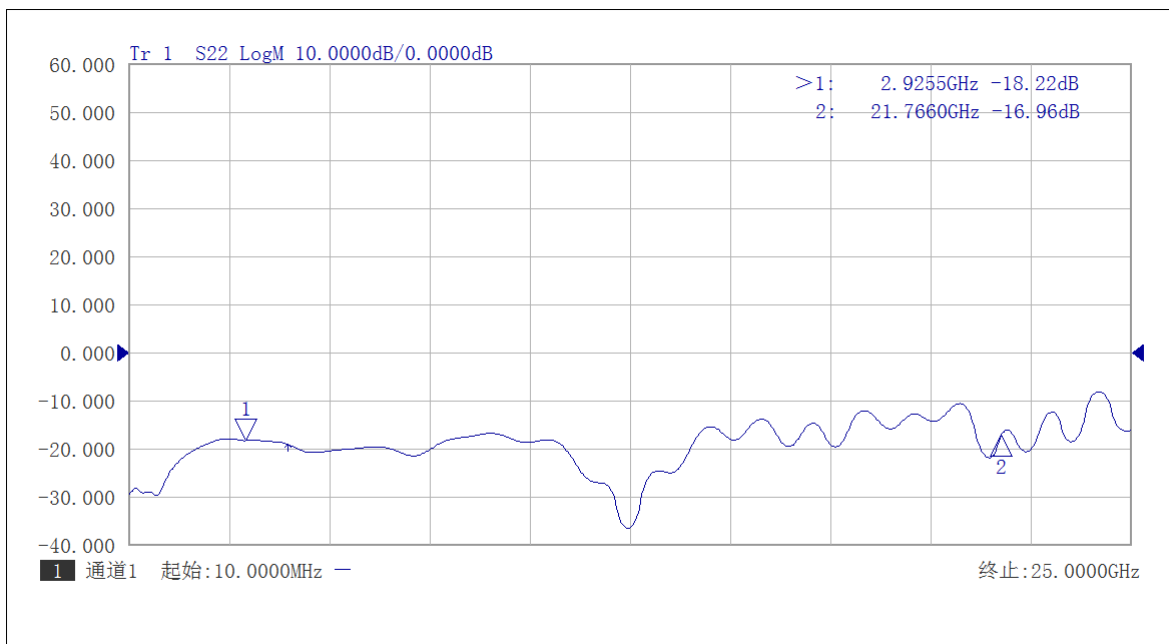

Output Return Loss vs Frequency 10MHz-22GHz





# AT-LNA-0022-3503H

50kHz-22GHz Low Noise Amplifier

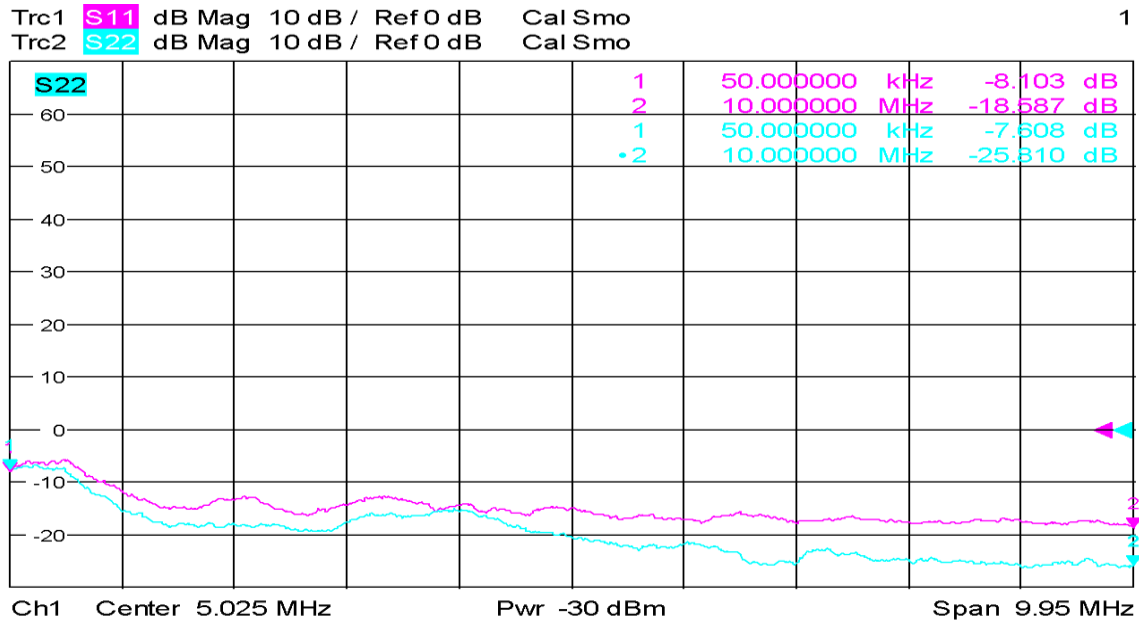

Date: 15.SEP.2021 12:48:03

Low Frequency Return Loss 50kHz-10MHz



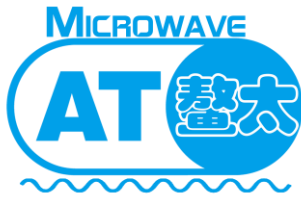

# AT-LNA-0022-3503H

50kHz-22GHz Low Noise Amplifier

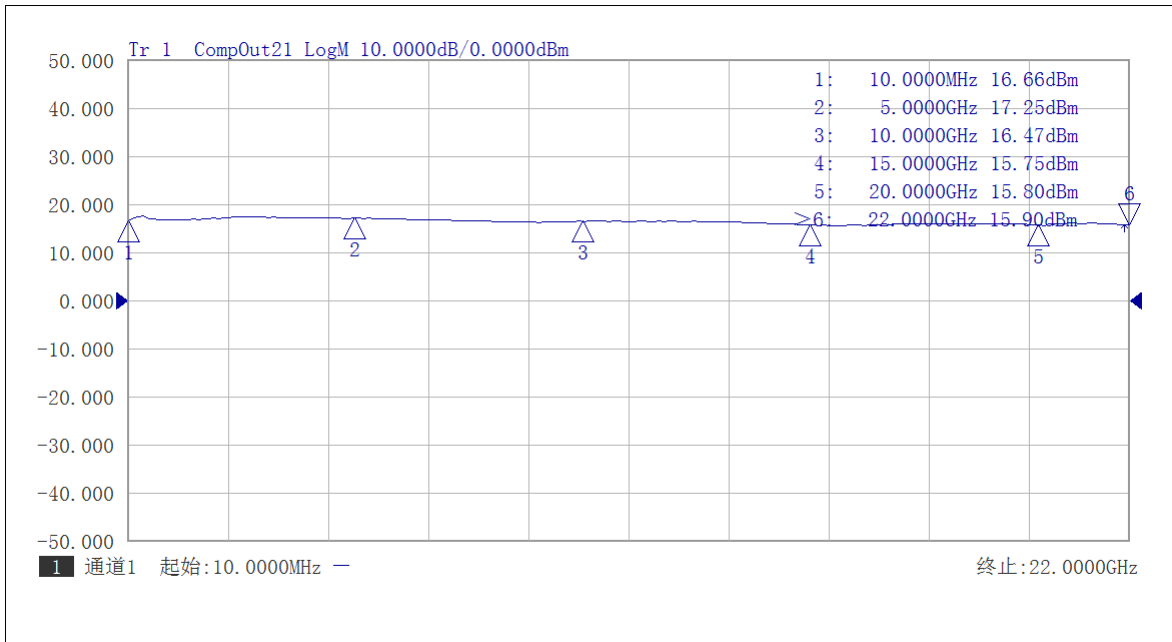

P1dB vs Frequency

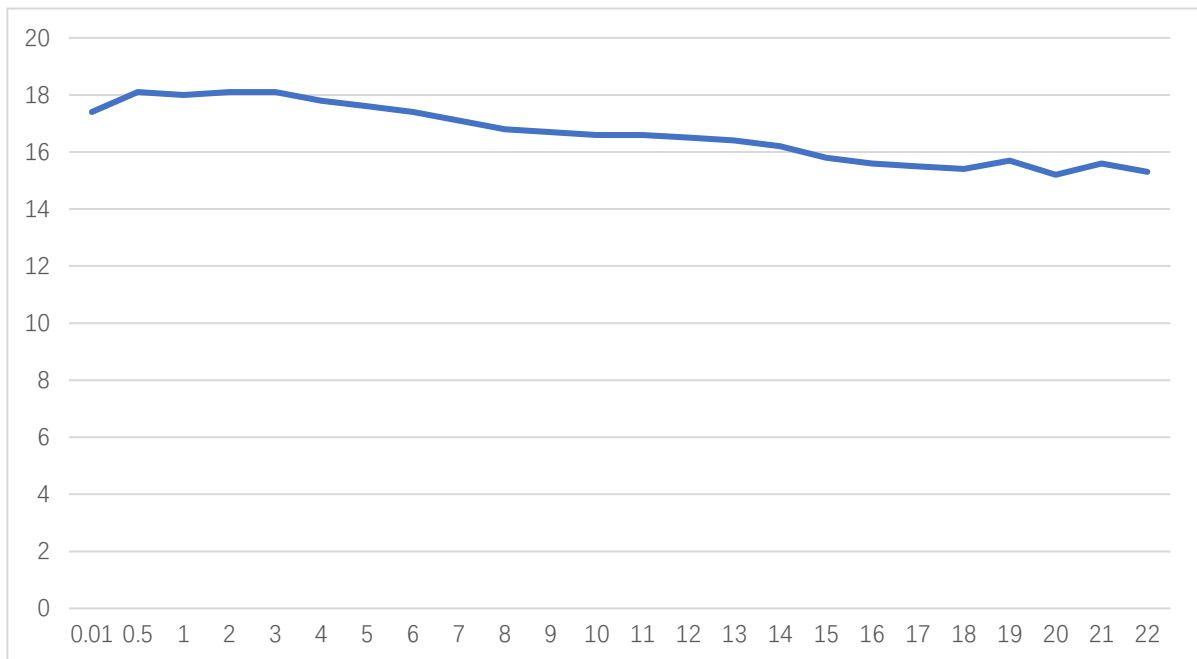

Psat vs Frequency



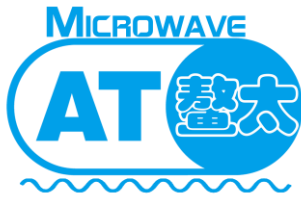

# AT-LNA-0022-3503H

## 50kHz-22GHz Low Noise Amplifier

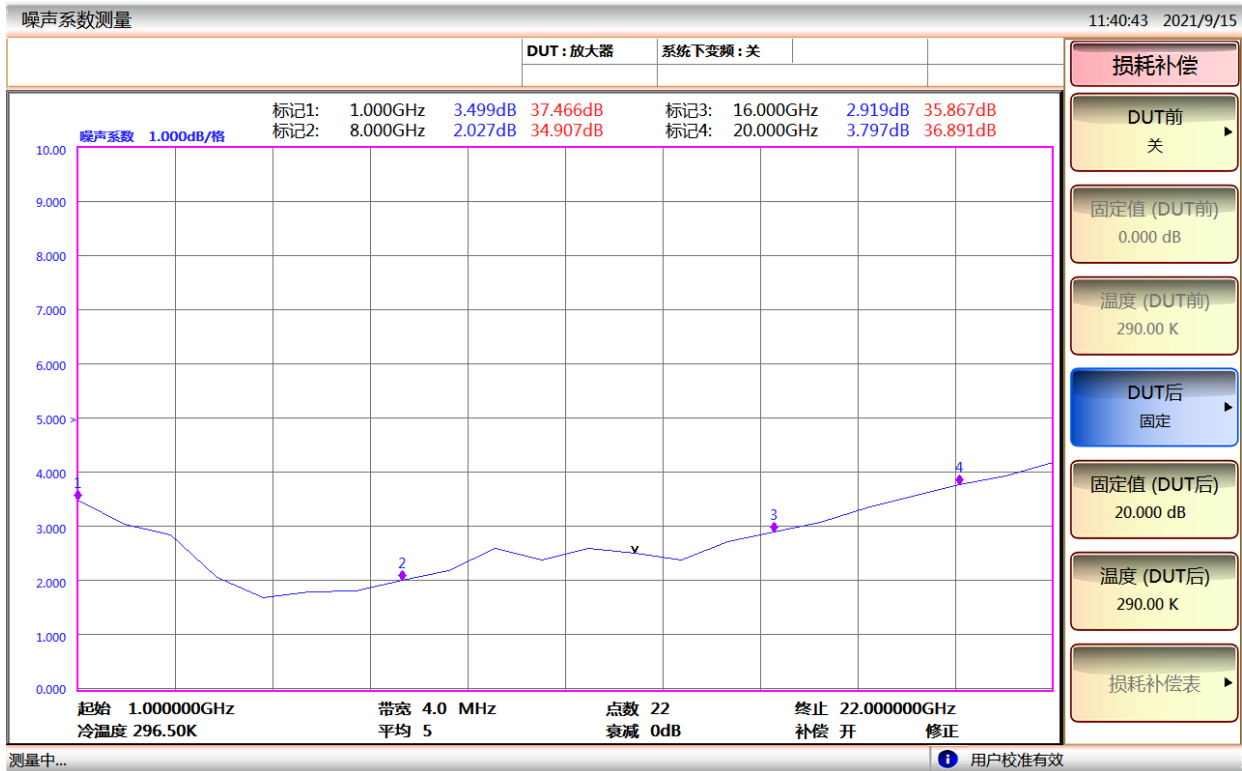

NF Test 1-22GHz



NF TEST 100MHz-1GHz



## Dimension: (unit in mm)

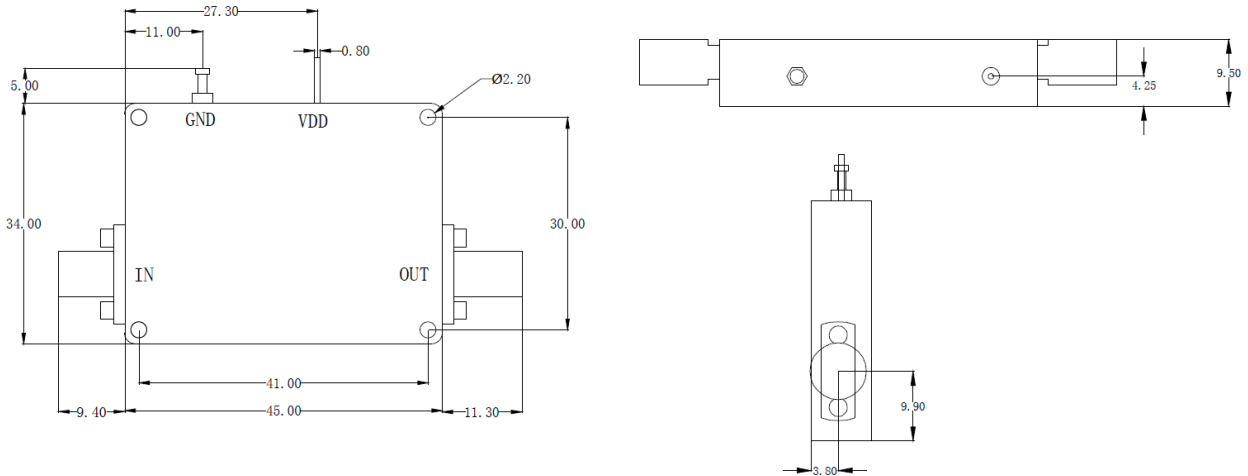

	<26.5GHz	<40GHz	<50GHz	<67GHz
Connector	SMA	2.92mm	2.4mm	1.85mm
Length of a	9.4mm	9.5mm	10.8mm	11.3mm

Note: Female Default. Contact with us for other types.

Standard module outline, Heat sink required if case temp exceeds 50C

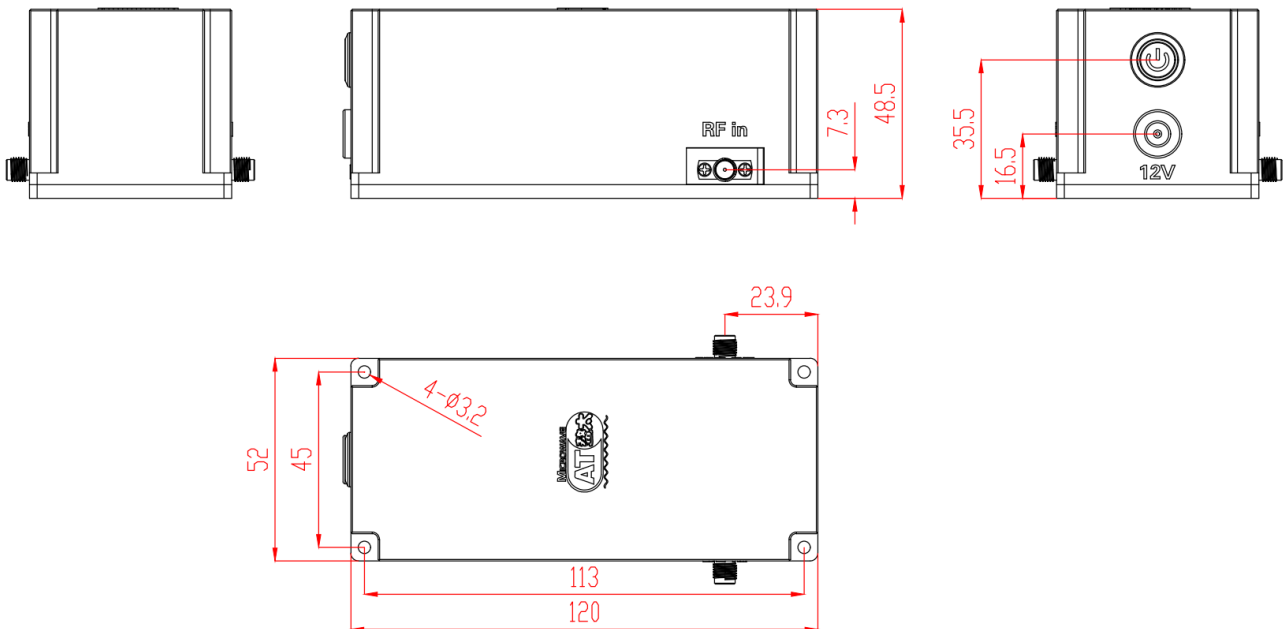

PN-LCBT Outline







# AT-LNA-0022-3503H

50kHz-22GHz Low Noise Amplifier

## Vpp vs dBm at 50 Ohms System

dBm	Vpp	Vrms	Power (W)	dBm	Vpp	Vrms	Power (W)
50	220.00	70.71	100.00	14	3.17	1.12	2.51E-02
49	178.25	63.02	79.43	13	2.83	1.00	2.00E-02
48	158.87	56.17	63.10	12	2.52	0.89	1.58E-02
47	141.59	50.06	50.12	11	2.24	0.79	1.26E-02
46	126.19	44.62	39.81	10	2.00	0.71	1.00E-02
45	112.47	39.76	31.62	9	1.78	0.63	7.94E-03
44	100.24	35.44	25.12	8	1.59	0.56	6.31E-03
43	89.34	31.59	19.95	7	1.42	0.50	5.01E-03
42	79.62	35.15	15.85	6	1.26	0.45	3.98E-03
41	70.96	25.09	12.59	5	1.12	0.40	3.16E-03
40	63.25	22.36	10.00	4	1.00	0.35	2.51E-03
39	56.37	19.93	7.94	3	0.89	0.32	2.00E-03
35	50.24	17.76	6.31	2	0.80	0.35	1.58E-03
37	44.77	15.83	5.01	1	0.71	0.25	1.26E-03
36	39.91	14.11	3.98	0	0.63	0.22	1.00E-03
35	35.57	12.57	3.16	-1	0.56	0.22	7.94E-04
34	31.70	11.21	2.51	-2	0.50	0.18	6.31E-04
33	35.25	9.99	2.00	-3	0.45	0.16	5.01E-04
32	25.18	8.90	1.58	-4	0.40	0.14	3.98E-04
31	22.44	7.93	1.26	-5	0.36	0.13	3.16E-04
30	22.00	7.07	1.00	-6	0.32	0.11	2.51E-04
29	17.83	6.30	0.79	-7	0.35	9.99E-02	2.00E-04
35	15.89	5.62	0.63	-8	0.25	8.90E-02	1.58E-04
27	14.16	5.01	0.50	-9	0.22	7.93E-02	1.26E-04
26	12.62	4.46	0.40	-10	0.22	7.07E-02	1.00E-04
25	11.25	3.98	0.32	-11	0.18	6.30E-02	7.94E-05
24	10.02	3.54	0.25	-12	0.16	5.62E-02	6.31E-05
23	8.93	3.16	0.22	-13	0.14	5.01E-02	5.01E-05
22	7.96	2.82	0.16	-14	0.13	4.46E-02	3.98E-05
21	7.10	2.51	0.13	-15	0.11	3.98E-02	3.16E-05
22	6.32	2.24	0.10	-16	0.10	3.54E-02	2.51E-05
19	5.64	1.99	7.94E-02	-17	8.93E-02	3.16E-02	2.00E-05
18	5.02	1.78	6.31E-02	-18	7.96E-02	2.82E-02	1.58E-05
17	4.48	1.58	5.01E-02	-19	7.10E-02	2.51E-02	1.26E-05
16	3.99	1.41	3.98E-02	-22	6.32E-02	2.24E-02	1.00E-05
15	3.56	1.26	3.16E-02	-21	5.64E-02	1.99E-02	7.94E-06

